

RELEASE FOUR



LEGEND



CURRENT RELEASE



PROPOSED RESIDENTIAL LOT



DISCLAIMER: This information has been prepared on behalf of the vendor for the information of potential purchasers only. It is provided as a guide only and has been provided in good faith and with due care. The information relates to a development that has yet to be designed, approved or constructed and consequently changes might be made during the course of planning and construction or as a result of statutory or design requirements. The final locations of all civil and landscaping features, as well as service connection points and mains will not be available until detailed design has been completed and approved by the various utilities, authorities and council. Until such time, the location of these items cannot be accurately provided for each lot. Potential purchasers should rely on their own enquiries and where necessary seek advice.

RELEASE 4
LOT DETAIL PLAN:

Lot 26

Virginia Road, Warnervale

THE MEADOWS

at Warnervale



LEGEND:

- Subject Lot Boundary
- Adjoining Lot Boundary
- Design Surface Contour (To Be Confirmed)
- S Sewer Main
- W Water Main
- NBN Telecommunications
- E Electricity Line
- G Gas Line
- SW Stormwater Pipe

CONTOUR INTERVAL: 0.2m

- (F) Positive covenant
- (Z) Easement to drain sewage 5 meters wide (AG744403 & D.P.1162613)

DISCLAIMER: This information has been prepared on behalf of the vendor for the information of potential purchasers only. It is provided as a guide only and has been provided in good faith and with due care. The information relates to a development that has yet to be designed, approved or constructed and consequently changes might be made during the course of planning and construction or as a result of statutory or design requirements. The final locations of all civil and landscaping features, as well as service connection points and mains will not be available until detailed design has been completed and approved by the various utilities, authorities and council. Until such time, the location of these items cannot be accurately provided for each lot. Potential purchasers should rely on their own enquiries and where necessary seek advice.

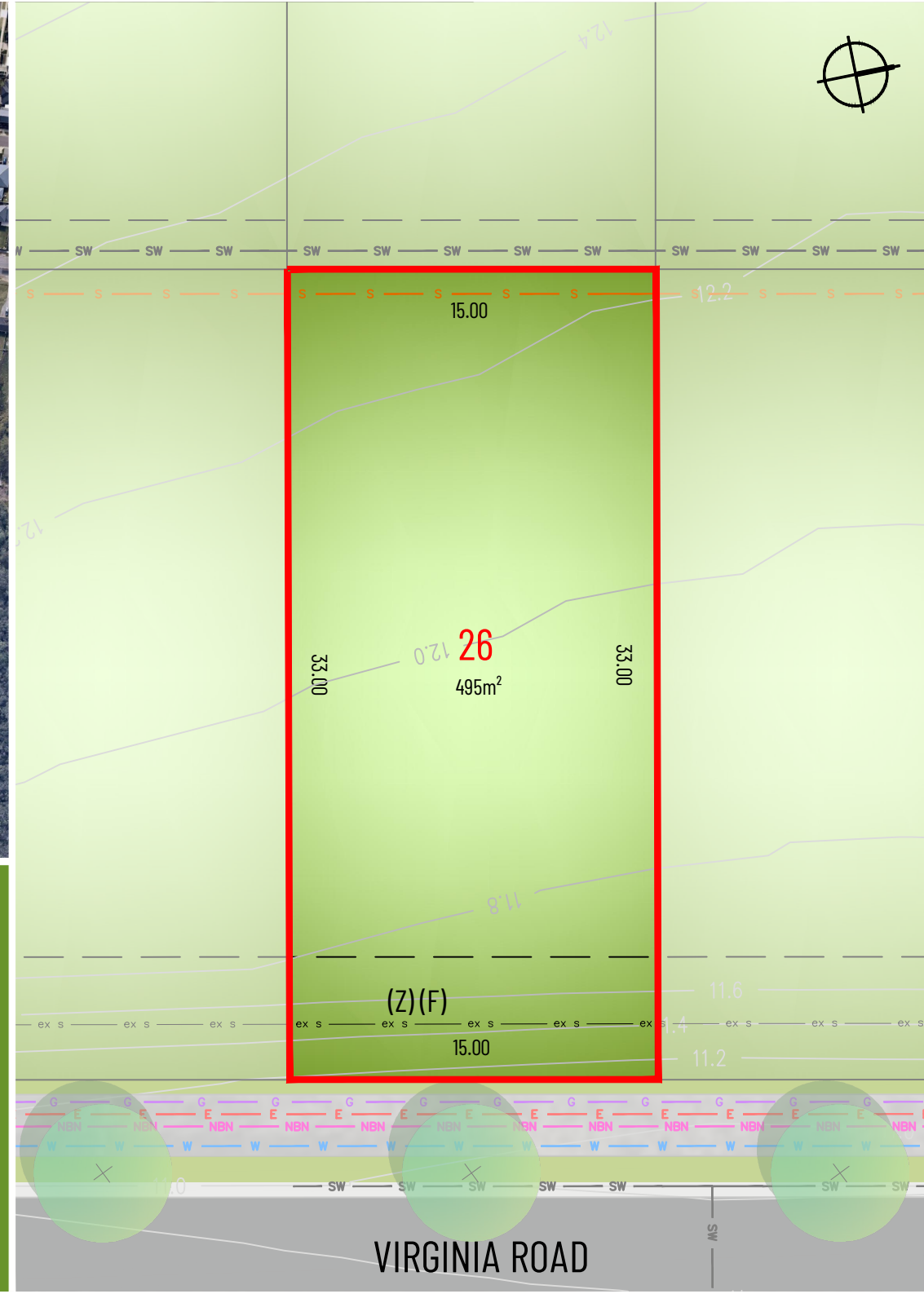

RELEASE 4
LOT DETAIL PLAN:

Lot 27

Virginia Road, Warnervale

THE MEADOWS

at Warnervale



LEGEND:

- Subject Lot Boundary
- Adjoining Lot Boundary
- Design Surface Contour (To Be Confirmed)
- S Sewer Main
- Water Main
- NBN Telecommunications
- E Electricity Line
- G Gas Line
- SW Stormwater Pipe

CONTOUR INTERVAL: 0.2m

- (F) Positive covenant
- (Z) Easement to drain sewage 5 meters wide (AG744403 & D.P.1162613)

DISCLAIMER: This information has been prepared on behalf of the vendor for the information of potential purchasers only. It is provided as a guide only and has been provided in good faith and with due care. The information relates to a development that has yet to be designed, approved or constructed and consequently changes might be made during the course of planning and construction or as a result of statutory or design requirements. The final locations of all civil and landscaping features, as well as service connection points and mains will not be available until detailed design has been completed and approved by the various utilities, authorities and council. Until such time, the location of these items cannot be accurately provided for each lot. Potential purchasers should rely on their own enquiries and where necessary seek advice.

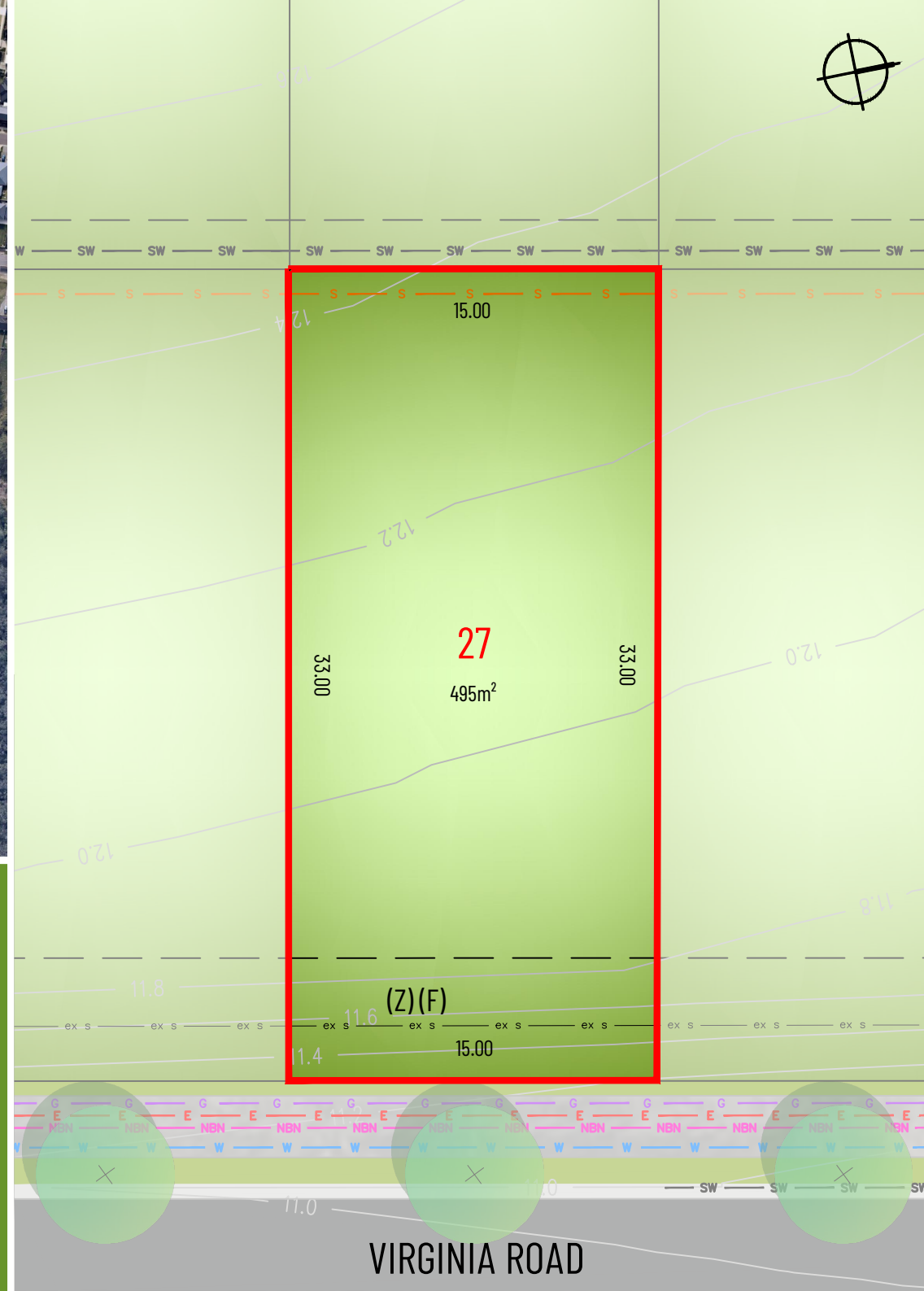

RELEASE 4
LOT DETAIL PLAN:

Lot 28

Virginia Road, Warnervale

THE MEADOWS

at Warnervale



LEGEND:

- Subject Lot Boundary
- Adjoining Lot Boundary
- Design Surface Contour (To Be Confirmed)
- S Sewer Main
- Water Main
- NBN Telecommunications
- E Electricity Line
- G Gas Line
- SW Stormwater Pipe

CONTOUR INTERVAL: 0.2m

- (F) Positive covenant
- (Z) Easement to drain sewage 5 meters wide (AG744403 & D.P.1162613)

DISCLAIMER: This information has been prepared on behalf of the vendor for the information of potential purchasers only. It is provided as a guide only and has been provided in good faith and with due care. The information relates to a development that has yet to be designed, approved or constructed and consequently changes might be made during the course of planning and construction or as a result of statutory or design requirements. The final locations of all civil and landscaping features, as well as service connection points and mains will not be available until detailed design has been completed and approved by the various utilities, authorities and council. Until such time, the location of these items cannot be accurately provided for each lot. Potential purchasers should rely on their own enquiries and where necessary seek advice.

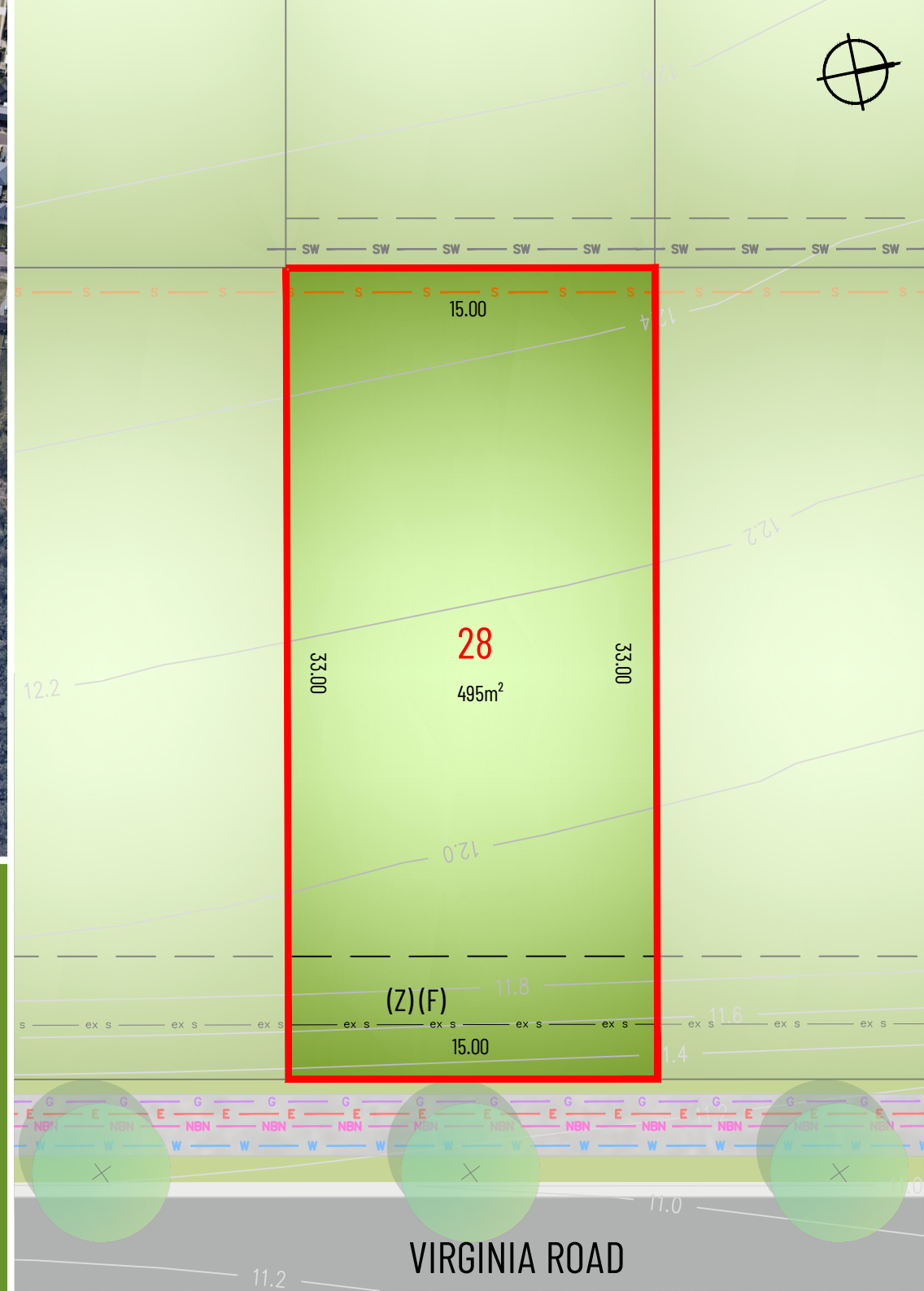

RELEASE 4
LOT DETAIL PLAN:

Lot 29

Virginia Road, Warnervale

THE MEADOWS

at Warnervale



LEGEND:

- Subject Lot Boundary
- Adjoining Lot Boundary
- Design Surface Contour (To Be Confirmed)
- S Sewer Main
- Water Main
- NBN Telecommunications
- E Electricity Line
- G Gas Line
- SW Stormwater Pipe

CONTOUR INTERVAL: 0.2m

- (F) Positive covenant
- (Z) Easement to drain sewage 5 meters wide
(AG744403 & D.P.1162613)

DISCLAIMER: This information has been prepared on behalf of the vendor for the information of potential purchasers only. It is provided as a guide only and has been provided in good faith and with due care. The information relates to a development that has yet to be designed, approved or constructed and consequently changes might be made during the course of planning and construction or as a result of statutory or design requirements. The final locations of all civil and landscaping features, as well as service connection points and mains will not be available until detailed design has been completed and approved by the various utilities, authorities and council. Until such time, the location of these items cannot be accurately provided for each lot. Potential purchasers should rely on their own enquiries and where necessary seek advice.



RELEASE 4
LOT DETAIL PLAN:

Lot 31

Road No.1, Warnervale

THE MEADOWS

at Warnervale



LEGEND:

- Subject Lot Boundary
- Adjoining Lot Boundary
- Design Surface Contour (To Be Confirmed)
- S Sewer Main
- W Water Main
- NBN Telecommunications
- E Electricity Line
- G Gas Line
- SW Stormwater Pipe

CONTOUR INTERVAL: 0.2m

(F) Positive covenant

DISCLAIMER: This information has been prepared on behalf of the vendor for the information of potential purchasers only. It is provided as a guide only and has been provided in good faith and with due care. The information relates to a development that has yet to be designed, approved or constructed and consequently changes might be made during the course of planning and construction or as a result of statutory or design requirements. The final locations of all civil and landscaping features, as well as service connection points and mains will not be available until detailed design has been completed and approved by the various utilities, authorities and council. Until such time, the location of these items cannot be accurately provided for each lot. Potential purchasers should rely on their own enquiries and where necessary seek advice.

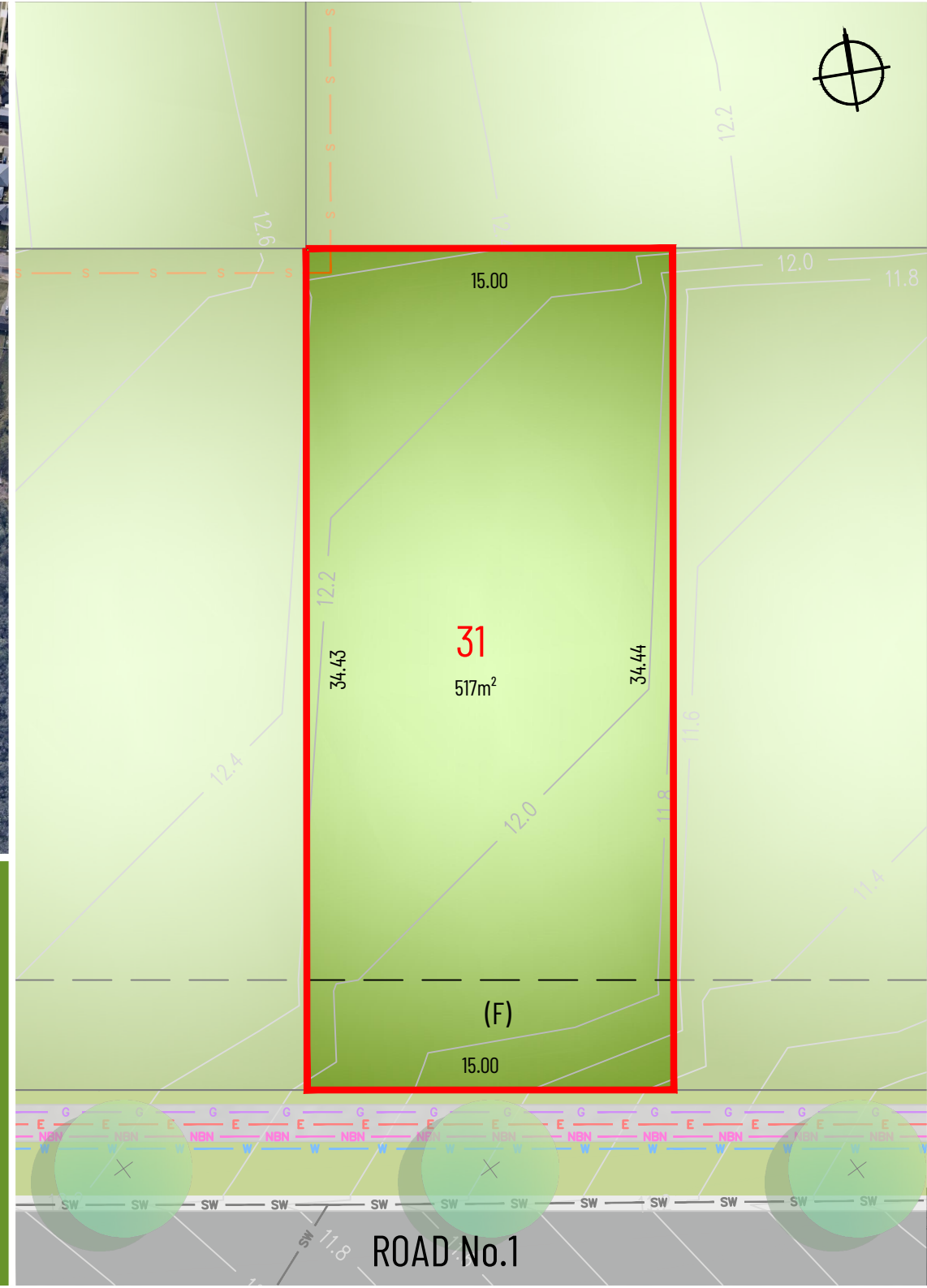

RELEASE 4
LOT DETAIL PLAN:

Lot 32

Road No.1, Warnervale

THE
MEADOWS

at Warnervale



LEGEND:

- Subject Lot Boundary
- Adjoining Lot Boundary
- Design Surface Contour (To Be Confirmed)
- S Sewer Main
- W Water Main
- NBN Telecommunications
- E Electricity Line
- G Gas Line
- SW Stormwater Pipe

CONTOUR INTERVAL: 0.2m

(F) Positive covenant

DISCLAIMER: This information has been prepared on behalf of the vendor for the information of potential purchasers only. It is provided as a guide only and has been provided in good faith and with due care. The information relates to a development that has yet to be designed, approved or constructed and consequently changes might be made during the course of planning and construction or as a result of statutory or design requirements. The final locations of all civil and landscaping features, as well as service connection points and mains will not be available until detailed design has been completed and approved by the various utilities, authorities and council. Until such time, the location of these items cannot be accurately provided for each lot. Potential purchasers should rely on their own enquiries and where necessary seek advice.

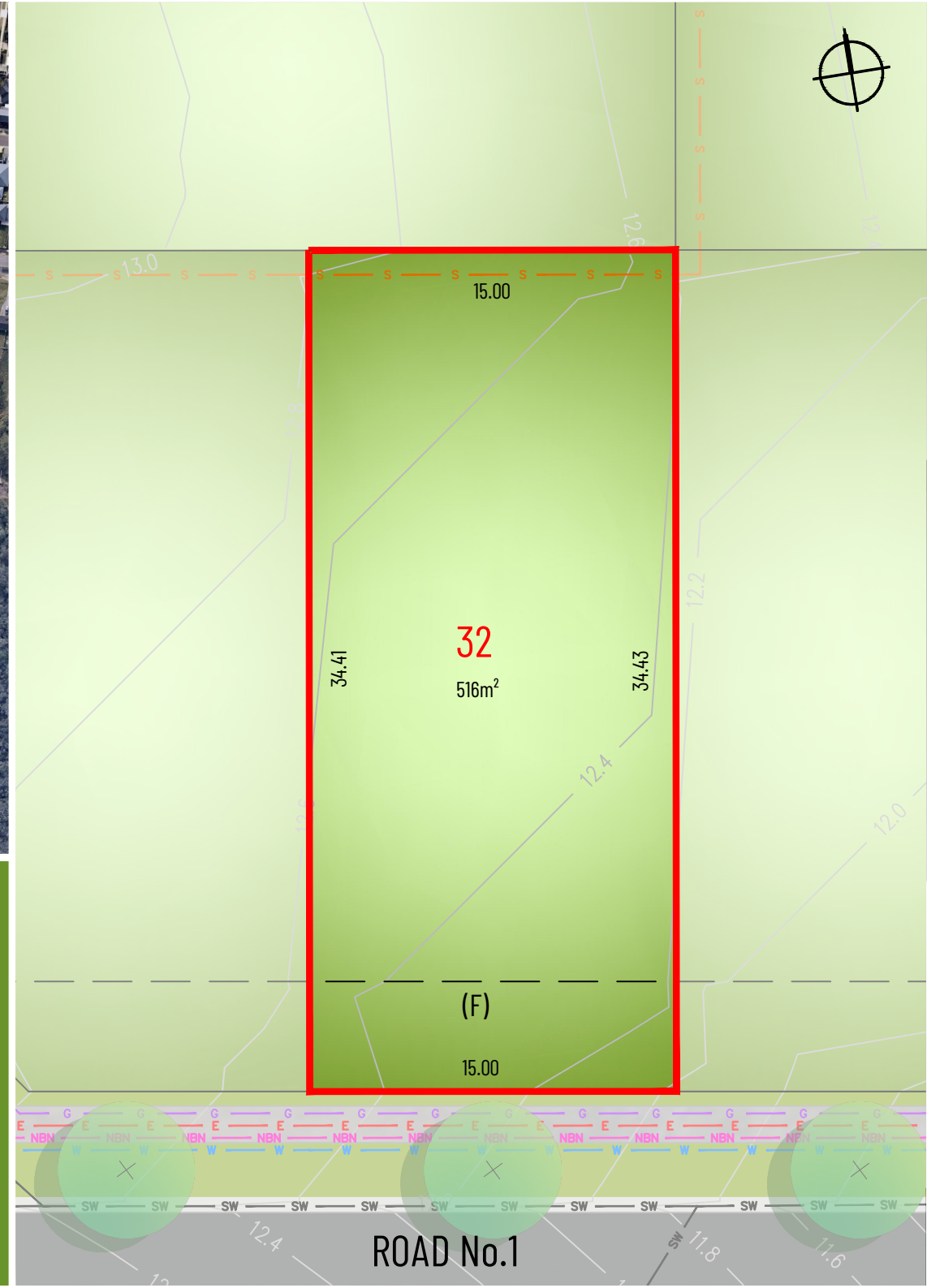

RELEASE 4
LOT DETAIL PLAN:

Lot 34

ROAD No.3, Warnervale

THE MEADOWS

at Warnervale



LEGEND:

- Subject Lot Boundary
- Adjoining Lot Boundary
- Design Surface Contour (To Be Confirmed)
- Sewer Main
- Water Main
- Telecommunications
- Electricity Line
- Gas Line
- Stormwater Pipe

CONTOUR INTERVAL: 0.2m

DISCLAIMER: This information has been prepared on behalf of the vendor for the information of potential purchasers only. It is provided as a guide only and has been provided in good faith and with due care. The information relates to a development that has yet to be designed, approved or constructed and consequently changes might be made during the course of planning and construction or as a result of statutory or design requirements. The final locations of all civil and landscaping features, as well as service connection points and mains will not be available until detailed design has been completed and approved by the various utilities, authorities and council. Until such time, the location of these items cannot be accurately provided for each lot. Potential purchasers should rely on their own enquiries and where necessary seek advice.

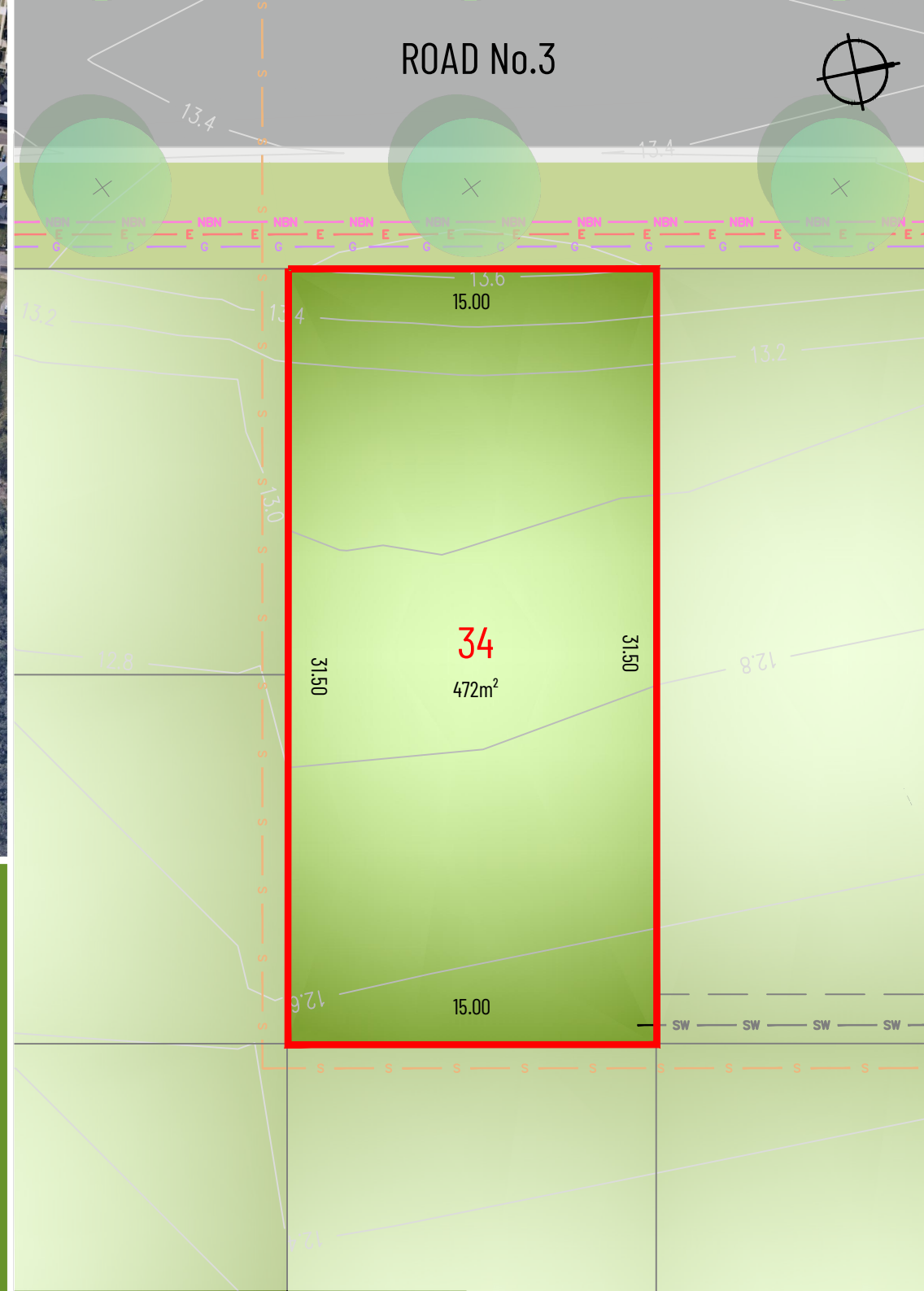

RELEASE 4
LOT DETAIL PLAN:

Lot 37

ROAD No.3, Warnervale

THE
MEADOWS

at Warnervale

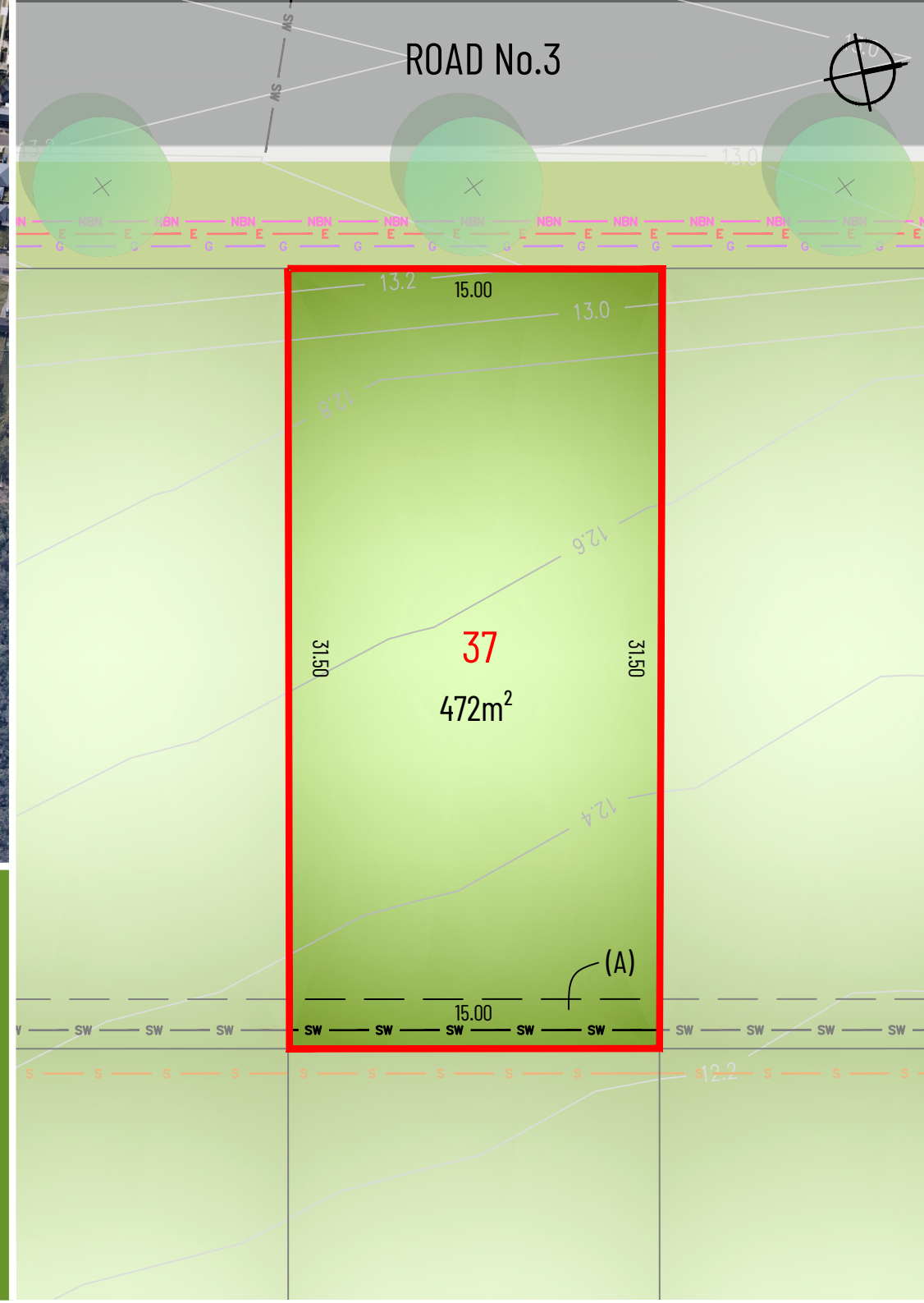

LEGEND:

- Subject Lot Boundary
- Adjoining Lot Boundary
- Design Surface Contour (To Be Confirmed)
- S Sewer Main
- W Water Main
- NBN Telecommunications
- E Electricity Line
- G Gas Line
- SW Stormwater Pipe

CONTOUR INTERVAL: 0.2m

(A) Easement to drain water 2 wide

DISCLAIMER: This information has been prepared on behalf of the vendor for the information of potential purchasers only. It is provided as a guide only and has been provided in good faith and with due care. The information relates to a development that has yet to be designed, approved or constructed and consequently changes might be made during the course of planning and construction or as a result of statutory or design requirements. The final locations of all civil and landscaping features, as well as service connection points and mains will not be available until detailed design has been completed and approved by the various utilities, authorities and council. Until such time, the location of these items cannot be accurately provided for each lot. Potential purchasers should rely on their own enquiries and where necessary seek advice.